



MASSILLON BUILDING DEPARTMENT
ONE JAMES DUNCAN PLAZA, MASSILLON, OH 44646
PHONE 330.830.1724 | FAX 330.830.1782
www.massillonohio.gov

SWIMMING POOL HANDOUT

MASSILLON CITY ORDINANCE REQUIREMENTS

SECTION 1187.14 PRINCIPLE USES PERMITTED SUBJECT TO SPECIAL CONDITIONS.

- (a) Private pools shall be permitted as an accessory use within the rear yard only, provided they meet the following requirements:
- (1) There shall be a minimum distance of not less than ten feet, between the adjoining property line, or alley right of way and the outside of the pool wall. Side yard setbacks shall apply to side yards if greater than ten feet.
 - (2) There shall be a distance of not less than four feet between the outside pool wall and any building located on the same lot.
 - (3) Swimming pools shall be located no less than thirty-five feet from any front lot line.
 - (4) No swimming pool shall be located in an easement.
 - (5) (A) For the protection of the general public, in-ground swimming pools shall be completely enclosed by a fence not less than four feet in height. The gates shall be a self-closing and latching type, with the latch on the inside of the gate not readily available for children to open. Gates shall be capable of being securely locked when the pool is not in use for extended periods. Provided, however, that if the entire premises of the residence is enclosed, then this provision may be waived by the Building Inspector upon inspection and approval.
(B) Above ground swimming pools with a pool wall height of four feet or greater measured from the surrounding grade and having a fold-up or removable ladder, shall not require fencing.
 - (6) A pool shall not be located less than twenty feet vertically, horizontally or diagonally to any overhead power lines or poles. (Ord. 218-2000. Passed 11-20-00.)

TO APPLY FOR A SWIMMING POOL PERMIT

1. A building permit application and a plot plan must be submitted to the Building Department for review and approval. The plot plan must show where the swimming pool will be located on the lot and how far off the property lines and away from the house the swimming pool will be.
2. If a Swimming Pool Contractor is installing the swimming pool, they must submit the application and plot plan and pull the permit before the job is started. All Swimming Pool Contractor's must be registered with the City of Massillon as a Home Improvement Contractor.
3. If a homeowner is installing the swimming pool, they may submit the paperwork and pull the permit themselves.
4. Once the paperwork has been received, it will take 1-3 days to be reviewed. If the paperwork is approved, a permit can then be issued.
5. In addition to the Building Permit for the swimming pool, if electric will be run to the pool, a separate Electrical Permit will need to be obtained. Likewise, if a gas line will be run, a separate Heating Permit will need to be obtained. Both the electrical and heating permits are the homeowner's responsibility to obtain and get inspected.
6. General electrical and gas line instructions for a swimming pool are as follows:
 - (A) NO DIRECT BURIAL; MUST BE IN CONDUIT
 - (B) ELECTRIC LINE MUST BE 18" DEEP; GAS LINE MUST BE 12" DEEP; THERE MUST BE 36" SEPARATION HORIZONTALLY OR VERTICALLY BETWEEN THE TWO.
 - (C) CALL FOR ELECTRIC & HEATING INSPECTION FOR A DITCH INSPECTION (BEFORE YOU COVER IT UP)
 - (D) CALL FOR A FINAL WHEN THE IT IS COMPLETED AND COVERED UP

SAMPLE PLOT PLAN

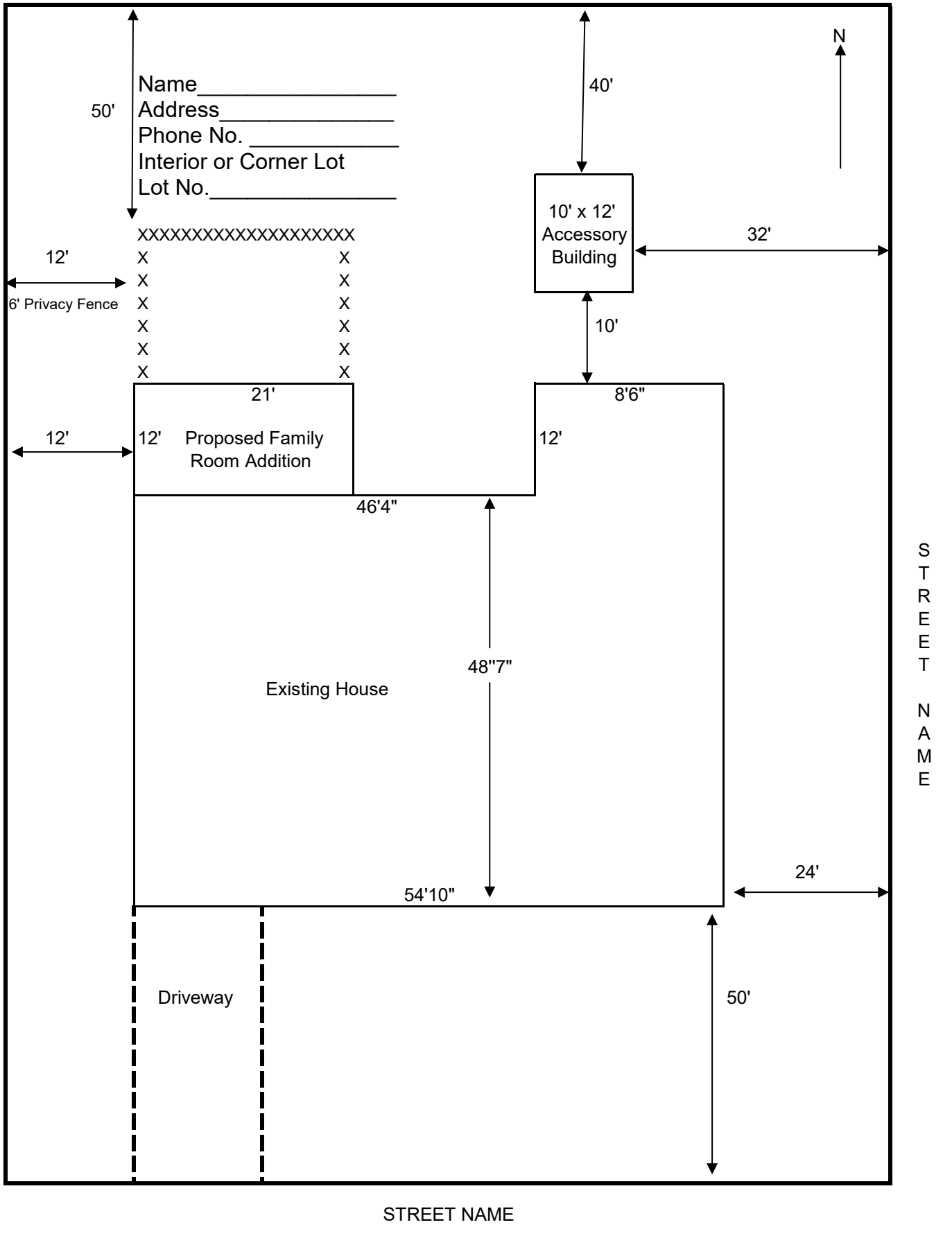



**CITY OF MASSILLON, OHIO
APPLICATION FOR BUILDING PERMIT**

DATE _____

TO THE BUILDING DEPARTMENT:

APPLICATION IS HEREBY MADE FOR PERMIT TO REPAIR/REMODEL/ERECT/RAZE A STRUCTURE AS HEREIN DESCRIBED: THE ACCEPTANCE OF WHICH SHALL CONSTITUTE AN AGREEMENT ON OWNER'S PART TO ABIDE BY ALL CONDITIONS HEREIN CONTAINED, AND TO COMPLY WITH ALL ORDINANCES OF THE CITY OF MASSILLON AND THE LAWS OF THE STATE OF OHIO RELATING TO THE WORK TO BE DONE HEREUNDER:

OWNER _____	ADDRESS _____ CITY/STATE/ZIP _____	PHONE _____ EMAIL _____
CONTRACTOR _____	ADDRESS _____ CITY/STATE/ZIP _____	PHONE _____ EMAIL _____

ELEC. CONTRACTOR _____ PHONE _____	PLUMB. CONTRACTOR _____ PHONE _____	HEATING CONTRACTOR _____ PHONE _____
---------------------------------------	--	---

JOB SITE LOCATION AND DESCRIPTION OF BUILDING AND PROPERTY:

NUMBER AND STREET _____
 _____ SIDE OF STREET SUBLOT NO. _____ ALLOTMENT _____

LOT } _____ FT. FRONT _____ FT. DEEP ON THE _____ SIDE
 BEING } _____ FT. REAR _____ FT. DEEP ON THE _____ SIDE

NUMBER OF STORIES _____ AND BASEMENT _____ **ESTIMATED COST OF JOB** _____

SIZE OF BUILDING: **WIDTH** _____ **DEPTH** _____ **TOTAL HEIGHT** _____

TYPE OF CONSTRUCTION: FRAME COMPOSITE MILL SLOW BURNING FIRE PROOF

SQ. FT. OF CONTENTS _____ HOW IS BUILDING TO BE OCCUPIED? _____ CLASS OF BLDG _____

IS STREET CURB IN TO ESTABLISH GRADE IN FRONT OF BUILDING? _____ BLDG GRADE NECESSARY _____

PERMIT FEE COST SCHEDULE:

FOOTER (\$30 EACH)	
FOUNDATION (\$30 EACH)	
ROUGH(S) (\$30 EACH)	
ADD'L INSPECTIONS (\$30 EACH)	
PLAN REVIEW	
PENALTY	
\$50 BASE PERMIT FEE (INCLUDES FINAL INSP.)	
\$5.00 PER THOUSAND OF ESTIMATED COST OF CONSTRUCTION (UP TO \$100,000)	
\$500 ABOVE +PLUS \$1.00 PER THOUSAND OF ESTIMATED COST OF CONSTRUCTION (OVER \$100,000)	
SUBTOTAL	
1% RESIDENTIAL ASSESSMENT FEE	
3% COMMERCIAL ASSESSMENT FEE	
TOTAL PERMIT FEE	

DETAILED DESCRIPTION OF WORK BEING DONE:

THE APPLICANT, AGENT, OWNER OF THIS BUILDING AND THE UNDERSIGNED AGREES: (1) TO CONFORM TO APPLICABLE LAWS OF THE CITY OF MASSILLON AND STATE OF OHIO. (2) IS RESPONSIBLE TO VERIFY THAT THE JOB LOCATION IS WITHIN THE CITY LIMITS. (3) NO REFUND WILL BE ISSUED. (4) THE ADDRESS IS CORRECT. (5) IS RESPONSIBLE FOR MAKING ARRANGEMENTS FOR ALL INSPECTIONS. (6) OWNER OR CONTRACTOR SHALL NOTIFY ALL UTILITY COMPANIES INVOLVED IN THE SITE AT LEAST FORTY-EIGHT HOURS BUT NOT MORE THAN TEN WORKING DAYS BEFORE COMMENCING EXCAVATION (ORC 3781.28).

SIGNATURE OF APPLICANT _____

FOR OFFICE USE ONLY:

BUILDING PERMIT

YOU ARE HEREBY GRANTED PERMISSION TO: REPAIR REMODEL ERECT RAZE

THE STRUCTURE AT THE ABOVE LISTED JOB SITE LOCATION IN THE CITY OF MASSILLON, OHIO, IN ACCORDANCE WITH YOUR APPLICATION ON FILE IN THIS DEPARTMENT, SAID STRUCTURE TO BE COMPLETED WITHIN ONE YEAR. UNTIL THAT TIME YOU HAVE PERMISSION TO OCCUPY ONE-THIRD OF THE STREET IN FRONT OF SAID LOTS. IF THE SIDEWALK IS OBSTRUCTED, A TEMPORARY SIDEWALK, FOUR FEET IN WIDTH AT LEAST, AS HIGH AS THE CURB LINE, MUST BE CONSTRUCTED AROUND THE OBSTRUCTION AND THE SIDE TOWARDS THE STREET TO BE TIGHTLY BOARDED UP TO 3 FEET IN HEIGHT ABOVE THE WALK, BUT AT ALL TIMES, YOU ARE TO COMPLY WITH THE ORDINANCES OF THE CITY OF MASSILLON AND THE LAWS OF THE STATE OF OHIO RELATIVE TO THE CONSTRUCTION, REMODELING AND ERECTING OF BUILDINGS. AND IN ADDITION THERETO, THE RECIPIENT OF THIS PERMIT SHALL INDEMNIFY AND SAVE HARMLESS THE CITY OF MASSILLON OR ANY PRIVATE INDIVIDUAL OR CORPORATION THAT MAY BE DAMAGED THROUGH THE CONSTRUCTION, REMODELING, ERECTION OR RAZING OF THE STRUCTURE.

_____, CHIEF BUILDING OFFICIAL

_____, DATE



MASSILLON BUILDING DEPARTMENT
ONE JAMES DUNCAN PLAZA, MASSILLON, OH 44646
PHONE 330.830.1724 | FAX 330.830.1782
www.massillonohio.gov

RESIDENTIAL FEES EFFECTIVE JANUARY 20, 2011

1305.03 Dwelling Plans Examination. All new dwellings and additions require plans examination. The fee for plans examination made by the Chief Building Official (Plans Examiner) for new or remodeled one- two- or three-family dwellings shall be \$75.00.

1305.04 Schedule of Fees for Building Permits.

Applications for all building permits shall be accompanied by payment of the following fee:

(1)	Standard Permit fee (Includes only the final inspection)	\$ 50.00
(2)	Each Rough Inspection	\$ 30.00
(3)	Any requested Inspection other than standard	\$ 50.00
(4)	Re-inspection fee for code violation	\$ 35.00
(5)	No Show re-inspection fee	\$ 75.00
(6)	Not requesting a Final Inspection	\$100.00

- (a) Permit fees shall be based on the estimated cost of construction including, but not necessarily limited to all sub trade costs.
- (b) A base fee of Fifty dollars (\$50.00) shall be charged for each permit issued.
- (c) In addition to the base fee in subsection (b) hereof the following fees shall be charged:

\$0.00- \$100,000.00	\$.50 per \$100.00 estimated cost of Construction
Over \$100,000.00	\$500.00 plus \$.10 per \$100.00 of estimated cost

All fees charged will be rounded off to the closest whole dollar amount.

A 1% State Assessment Fee will be added to the total permit fee.